

EB
01

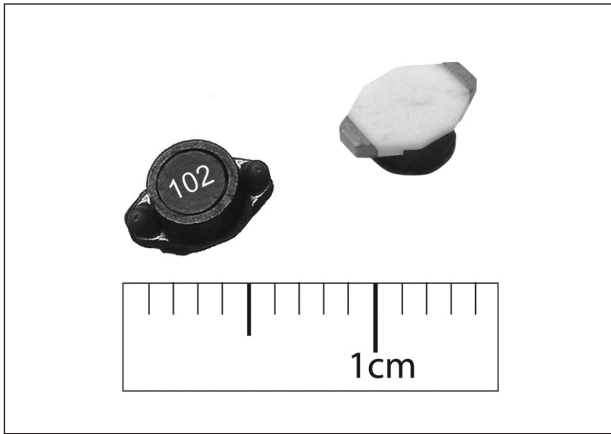

● PART NUMBERING

EB - □□□ □ □□ □□ □□
(1) (2) (3) (4) (5) (6)

- (1) Series
- (2) Inductance
- (3) Tolerance
- (4) Dimension
- (5) Material
- (6) Internal Serial No.

● FEATURES

- Magnetic shielded surface mount power inductors.
- Exceptionally low DC resistance and high energy storage.
- Designed with a flat top and constructed of heat resistant materials for pick and place operations and reflow process.

● APPLICATIONS

- DC/DC converters
- Step-up or Step-down converters
- Computers and portable power devices
- LCD displays

● CONFIGURATIONS & DIMENSIONS

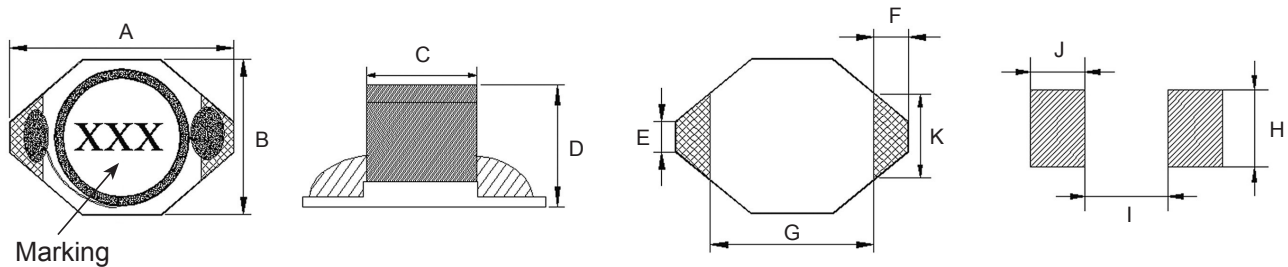

Unit : mm

SERIES	A	B	C	D	E	F	G	H	I	J	K
EB-63B	6.6 Max.	4.45 Max.	2.92 Max.	4.06 Typ.	1.27 Typ.	1.02 Typ.	4.32 Typ.	3.05 Typ.	4.06 Typ.	1.40 Typ.	3.56 Typ.

• For packaging information, please refer to page P.95.

● ELECTRICAL CHARACTERISTICS

New Part No.	Old Part No.	L (μ H)	SRF (MHz, Typ.)	DCR (Ω , Max.)	Isat (A, Max.)	Irms (A, Max.)
EB-10A□63B□□	SDOSG1608-1R0□	1.0	250	0.04	3.60	3.00
EB-15A□63B□□	SDOSG1608-1R5□	1.5	125	0.45	3.36	2.80
EB-22A□63B□□	SDOSG1608-2R2□	2.2	120	0.05	2.16	1.80
EB-33A□63B□□	SDOSG1608-3R3□	3.3	120	0.55	1.92	1.60
EB-47A□63B□□	SDOSG1608-4R7□	4.7	105	0.06	1.68	1.40
EB-68A□63B□□	SDOSG1608-6R8□	6.8	50	0.065	1.44	1.20
EB-100□63B□□	SDOSG1608-100□	10	38	0.075	1.20	1.00
EB-150□63B□□	SDOSG1608-150□	15	33	0.09	0.96	0.80
EB-220□63B□□	SDOSG1608-220□	22	25	0.11	0.84	0.70
EB-330□63B□□	SDOSG1608-330□	33	20	0.19	0.72	0.60
EB-470□63B□□	SDOSG1608-470□	47	20	0.23	0.60	0.50
EB-680□63B□□	SDOSG1608-680□	68	15	0.29	0.48	0.40
EB-101□63B□□	SDOSG1608-101□	100	10	0.48	0.36	0.30
EB-151□63B□□	SDOSG1608-151□	150	9	0.59	0.31	0.26
EB-221□63B□□	SDOSG1608-221□	220	6	0.77	0.26	0.22
EB-331□63B□□	SDOSG1608-331□	330	5	1.40	0.24	0.20
EB-471□63B□□	SDOSG1608-471□	470	4	1.80	0.22	0.19
EB-681□63B□□	SDOSG1608-681□	680	3	2.20	0.21	0.18
EB-102□63B□□	SDOSG1608-102□	1000	2	3.4	0.18	0.15
EB-152□63B□□	SDOSG1608-152□	1500	2	4.2	0.14	0.12
EB-222□63B□□	SDOSG1608-222□	2200	2	8.5	0.12	0.10
EB-332□63B□□	SDOSG1608-332□	3300	1	11.0	0.09	0.08
EB-472□63B□□	SDOSG1608-472□	4700	1	13.9	0.07	0.06
EB-682□63B□□	SDOSG1608-682□	6800	1	25.0	0.04	0.04
EB-103□63B□□	SDOSG1608-103□	10000	0.8	32.8	0.02	0.02

EB
02

- Tested at 25°C, 100KHz, 0.1V.
- Temperature rise : 30°C Typ. at Irms
- Inductance drop : 10% Typ. at Isat
- Operating temperature : -55°C to +105°C
- Storage temperature : -40°C to +85°C